

Installing the Office 365 Client using the Software Center

Before beginning the installation process, make sure to close any Office products (Word, Excel, PowerPoint, ect.)

The total time for the installation to complete should be around 30 minutes but can take up to an hour.

Using your search bar in Windows 10, search for Software Center. You can also open Software Center through the Start Menu in the "Microsoft System Center" folder.

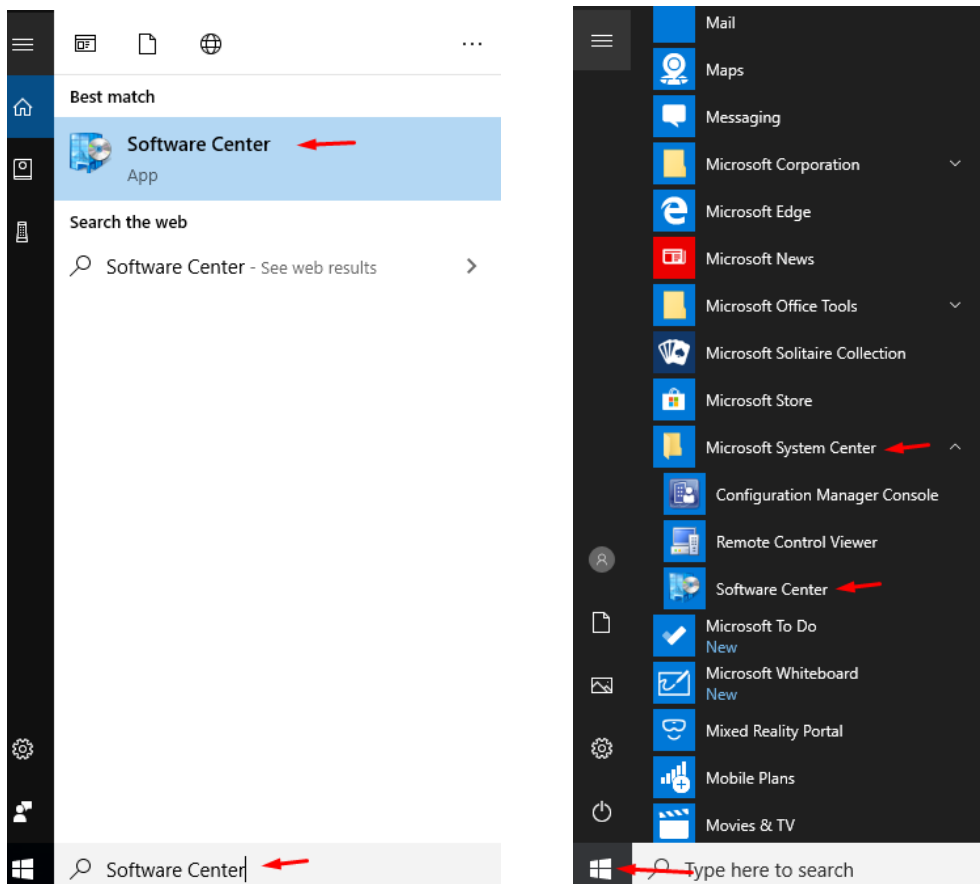

When the Software Center opens, it will begin searching for available applications. You should see Office 365 Pro Plus listed. Click on it.

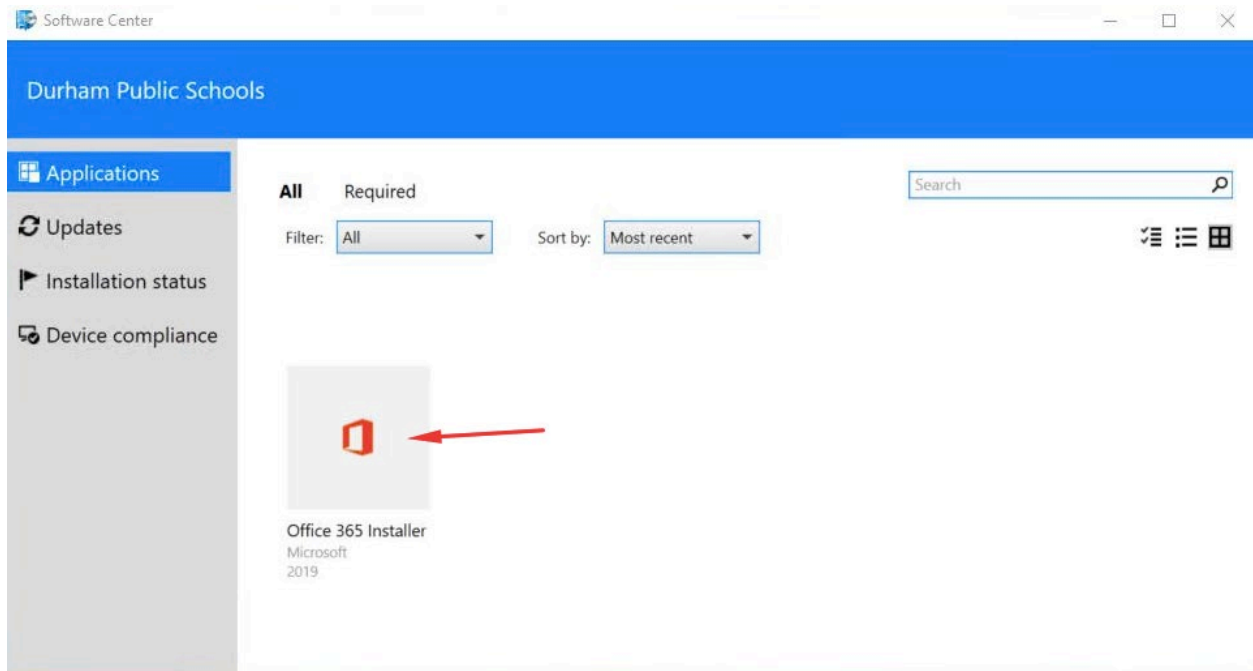

On the next screen, click the Install button to begin the installation of Office 365 on your machine.

